

ROADLIGHTING | 2014 |

Innovation · Efficiency · Safety

11-12 March

Auckland

New Zealand



Arm yourself for
the lighting revolution

Join the master class on LED road lighting
and smart control strategies



Road Lighting 2014 is the brainchild of specialist consultancy Strategic Lighting Partners (SLP) Ltd, which delivers strategic advice and business case analysis for new-generation New Zealand and Australian road lighting projects. SLP is particularly experienced in facilitating the collation and analysis of information on LED road lighting applications for councils and road controlling authorities in both countries. Find out more at www.strategiclightingpartners.com or e-mail godfrey@strategiclightingpartners.com

Welcome to Road Lighting 2014:

Innovation • Efficiency • Safety

Welcome to the inaugural New Zealand conference and exhibition for road lighting professionals and road controlling authorities, *Road Lighting 2014: Innovation • Efficiency • Safety*.

LED lighting is driving a revolution in road lighting infrastructure that can deliver a quantum leap in cost-competitive efficiencies. It uses half the electricity of high-pressure sodium lighting, reduces maintenance costs by up to 75 per cent, enables easier and more precise lighting control, and helps create safer road conditions.

International experience is now also demonstrating that LED lighting is only half the story and that smart control systems offer an exciting glimpse of our smart cities of the future.

Councils throughout New Zealand face a common set of challenges: how to harness the newly available technologies and techniques, and how to make procurement decisions that indemnify councils from risk. This conference has been established to help provide some of the answers.

Experts from seven nations are transforming *Road Lighting 2014* into a “master class” on LED road lighting and smart control strategies for local government and the road lighting industry “down under”.

Hailing from the United States, Canada, UK, France, Norway and Australia, as well as New Zealand, the speaker line-up has turned this Auckland event into a unique international networking opportunity.

The commercial exhibition will feature technology available from NZ and Australian specialists, along with top manufacturers from US, Canada, UK and Europe. Contractors and services suppliers of infrastructure finance, consultancy, smart construction, energy services and energy performance contracting are also on hand.

A big thank you to our partners, the Energy Efficiency and Conservation Authority (EECA) and the NZ Transport Agency (NZTA), who have shared our vision for this conference. And thanks also to supporters who have endorsed the concept, including Local Government New Zealand (LGNZ), the Road Controlling Authorities (RCA) Forum, the Illuminating Engineering Society of Australia and NZ (IESANZ), Lighting Council NZ (LCNZ), the Society of Local Government Managers (SOLGM) and the Energy Management Association of NZ (EMANZ).

Our commercial sponsors have played a key role in bringing the conference to fruition, including GE Lighting, Citelum Australia, Harvard Engineering plc, Transfield Services, Silver Spring Networks, Westpac Institutional Bank and NZ-based engineering consultancy Beca.

We hope you are stimulated and inspired!

Strategic Lighting Partners Ltd



Godfrey Bridger MBA, ME
Managing Director
Strategic Lighting Partners Ltd



Bryan King
MBA, DipBIA, NZCE, MIES
Director, Strategic Lighting Partners Ltd



Crystal Beavis
MA (Hons), PGCertMgmt, APR, MPRINZ
Director, Strategic Lighting Partners Ltd

Conference Speakers Day 1: Tuesday 11 March



Len Brown

Mayor of Auckland

Len Brown was elected Mayor of Auckland in 2010 and re-elected in 2013. His vision is for Auckland to be the world's most liveable city. A University of Auckland law graduate, Len's political career began in 1992 as Manukau City Councillor for Otara, later becoming Mayor of Manukau. Under his leadership, Auckland has developed a 30-year regional development blueprint, launched an Economic Development Strategy, and improved its standing in all three major international quality-of-life surveys, placing in the top 10 of the Economist Intelligence Unit's Global Liveability Report, Monocle magazine's Most Liveable Cities Index and the Mercer Quality of Living Survey.



Lawrence Yule

LGNZ President and Mayor of Hastings

Lawrence is the President of Local Government New Zealand, elected in July 2008. Before being elected President he served as a provincial sector chair and member of the National Council of Local Government New Zealand, with special responsibilities for the transport and water portfolios. He is patron of several local groups and organisations, and takes a keen interest in organisations that operate to support the community of Hastings. He has been Mayor of Hastings District since 2001. Lawrence has an Honours Degree in Engineering, and has recently been made a Fellow of the Institute of Professional Engineers.



Ed Ebrahimian

Director, Bureau of Street Lighting,
City of Los Angeles.

Ed Ebrahimian has more than 26 years of experience in the Bureau of Street Lighting and oversees and manages all policies, programs, and activities of the Bureau. The City of Los Angeles has the 2nd largest municipal street lighting system in the United States with over 200,000 streetlights. This system provides illumination to more than 4,500 miles of streets. Ed Ebrahimian has overseen the largest international retrofit of urban LED road lighting resulting in cost savings of \$7.5 million in electricity and \$2.5 million in maintenance, and a significant reduction in street crime.



Dr Ron Gibbons

Director, Centre for Infrastructure Based Safety Systems, Virginia Tech Transportation Institute

Dr Gibbons is Virginia Tech's lead lighting and visibility researcher in roadway-based safety systems. He is the author of several published papers on roadway lighting, photometry and target visibility showing that lighting and visibility are critical to the safety of motorists, pedestrians, and bicyclists on roadways, parking lots and garages. His research examines the effect of the spectral components of lighting and the use of adaptive lighting technologies that will adjust lighting based on need. Dr Gibbons is a past president and Fellow of the Illuminating Engineering Society of North America.



Margaret Newman

Former Chief of Staff, New York City Department of Transportation, Executive Director Municipal Art Society.

Margaret Newman has coordinated major departmental projects with a focus on sustainable design, providing design overview and project direction for the Urban Design and Art Division. She led the development of the City's Street Design Manual, its LED road lighting pilot programme and decision to replace 250,000 road lights with LED, and contributions to key policy documents including Sustainable Streets, Green Light and World Class Streets. Her new role consolidates her position as an advocate for intelligent urban design, planning and preservation. She is a former partner of New York City-based Marren and Newman Architects, and a Fellow of the American Institute of Architects.



Edward Smalley

Director, US Department of Energy's Municipal Solid-State Street Lighting Consortium (MSSLC)

As Director of the MSSLC, Edward Smalley is responsible for a programme to collect, analyse, and share information related to LED street and area lighting applications for a membership of more than 400 US municipalities and utilities. As Manager of Seattle City Light's Streetlight Engineering Unit, he was the chief architect of Seattle's conversion to LED street lighting technology. Edward Smalley is the Executive Chair of the Illuminating Engineering Society's Street and Area Lighting Committee, and is a Lighting Certified Professional with more than 25 years of experience in the design, construction and operation of public outdoor lighting systems.



Graham Mawer

Director, Next Energy; and Program Manager, Street Lighting Improvement Program, Southern Sydney Regional Organisation of Councils (SSROC)

Graham Mawer has worked in the Australian utilities sector since 1996 on energy efficiency and renewable energy projects. Graham leads Next Energy's street lighting practice and is Program Manager of a major street lighting initiative for 35 local governments in the Sydney area. He also works for other private and public sector clients on street lighting projects. Graham has a B.A.Sc. in Mechanical Engineering from the University of Toronto and an MBA from McGill University in Montreal.



Paul Gowans

Principal Engineer, Electrical & Furniture, City of Sydney.

Paul has extensive experience in consultancy and Local Government road lighting management in his native Scotland and has been the spearhead of the recent City of Sydney LED trial program and large scale CBD LED deployment. He is also undertaking extensive trials of CMS technology and is a member of the AS/NZS 1158 road lighting standards committee.

ROADLIGHTING | 2014 |

Innovation · Efficiency · Safety



Terry Collins

General Manager Products, Energy Efficiency and Conservation Authority (EECA)

Terry is a member of EECA's senior leadership team. He has a background in policy, quality management systems, regulatory compliance and standards development. He is responsible for

relationship management with Australian Federal and State agencies who participate in the Trans-Tasman, Equipment Energy Efficiency Programme that set joint mandatory product energy efficiency standards for New Zealand and Australia. Terry is also the Chair of the APEC Expert Group on Energy Efficiency and Conservation.



Richard Webster

Electrical Services Manager ITS & Street Lighting, Suffolk County Council, UK

Richard Webster has over 22 years of experience within the lighting industry working in the private and public sectors. He is responsible for the management of over 90,000 lighting assets

within Suffolk where 60,000 street lights are connected to a central management system (CMS) after completion of an 18 month project; 42,000 of these operating on part night control. The CMS coupled with part night lighting has enabled annual energy savings of £650,000 and CO2 savings of 3600 tonnes, with a reduction in crime levels during the 'lights off' period.



Christophe Orceau

Chairman of the Steering Committee, TALQ Consortium, Paris

Christophe Orceau is the founder of Streetlight.Vision, the software company that develops open Central Management Software for Smart Streetlight and Smart City applications, and the

Chairman of the Steering Committee for the TALQ Consortium which provides a standard interface between Central Management Software and various proprietary Road Lighting Networks. Streetlight.Vision is committed to open systems that aim to integrate manufacturers products to unlock the Streetlight Control and Monitoring market and to allow cities to run their networks with "less energy and more control". The company has managed 450 projects in 15 countries, of which the largest streetlight control projects are in Oslo, Paris, Dublin, Dongguan (China) and Jakarta.



Chris Byrne

Chairman, Lighting Council New Zealand; Managing Director, Thorn Lighting New Zealand

Chris has more than 30 years' experience in the New Zealand Lighting Industry, having worked for a number of companies covering a

range of responsibilities from lighting design, through sales and sales management, Luminaire Design and senior management. Recently Chris has been involved in the instigation of Better Road lighting in NZ, including the installation of Road Lighting Control Systems.



Nancy Clanton

Founder and President of Clanton & Associates, Chair IES Outdoor Environmental Lighting Committee & IES Mesopic Committee

Nancy Clanton's firm specialises in sustainable lighting design. She is a highly-awarded registered Professional Engineer and a member of the National Science

Foundation committee on solid state lighting. Last year she received the ACEC Colorado 2013 Outstanding Woman Engineer Award and the International CleanDesign Award. She chairs two IES committees, and is a past Director of the International Association of Lighting Designers, International Dark Sky Association, and the Illuminating Engineering Society. Ten Clanton & Associates projects have been named to the AIA Committee on the Environment Earth Day Top Ten List, and 13 designs have won LEED Platinum rating for other projects. She has led NEEA-funded research showing white light improves driver reaction time.



Bill Frith

Research Leader (Road Safety), Opus International Consultants

Bill has worked in the Transport Sector since 1973. Before joining Opus in mid-2007, he was Manager Research and Statistics at the Ministry of Transport. He also managed the Austroads Safety Program from 2004 to 2006. He has expertise in all aspects of road safety. Recent projects include work on the reflective properties of New Zealand pavements, the safety impact of road lighting, pedestrian safety, older driver safety, safe speed, the impact of demographic change on travel and safety, quadbike safety and fuel efficient driving. Bill is a Fellow of the Chartered Institute of Logistics and Transport and a Life Member of the Transportation Group of IPENZ.



Godfrey Bridger

Director, Strategic Lighting Partners Ltd

Godfrey is an experienced CEO and senior manager with over 15 years management consultancy experience. SLP was established after Godfrey was commissioned by NZTA to write a report on "Strategic Road Lighting Opportunities for New Zealand" and called on Bryan

King's assistance. SLP has since written business cases for city councils to upgrade their street lighting to LED. Godfrey is a former CEO of EECA, former board member of Mercury Energy and former elected member of the Auckland Regional Services Trust which then owned the City's independent businesses including Watercare Services and Ports of Auckland, and which developed the Americas Cup Challenge infrastructure to catalyse the redevelopment of Auckland's city harbourscape.







Bill Ralston, After Dinner Speaker

Bill Ralston's career as a journalist and broadcaster spans more than thirty years, working in television, radio, print and online. A political reporter with TV ONE News during the turbulent Eighties, Bill was TV3's political editor in Parliament for several years during the Nineties and he has hosted political discussion programmes on TV ONE,

TV3, Sky and Prime in recent years. Bill was Head of News and Current Affairs at TVNZ for nearly four years and, prior to that, he edited Metro Magazine. Bill currently works as a writer, commentator, and political consultant.

Conference Speakers Day 1: Tuesday 11 March

 GE Lighting	DAY 1: Tuesday 11 March	Time	Speaker	Nat	Topic
	REGISTRATION	8:00 am	Registration and Networking, tea/coffee		GE Lighting Luminaire Supplier sponsorship
	CONFERENCE OPENING	8:55 am	Introduction Strategic Lighting Partners Ltd	NZ	
		9:00 am	Official Welcome by His Worship the Mayor of Auckland, Len Brown	NZ	
		9:10 am	Official Opening - President of Local Government NZ, Mayor Lawrence Yule	NZ	
	THE US EXPERIENCE	9:20 am	Ed Ebrahimian, Director, Los Angeles Bureau of Lighting, City of Los Angeles	USA	140,000 LEDs - The City of Los Angeles Experience
9:55 am		Dr Ron Gibbons, Director of the Centre for Infrastructure Based Safety Systems - Virginia Tech Transportation Institute	USA	Quantifying the impact of road lighting on safety: Guidance for implementation	
 Transfield Services	MORNING TEA	10:30 am	Morning Tea, Exhibition and Networking		Transfield Services – Construction & Maintenance Contractor sponsorship
	THE US EXPERIENCE (Cont.)	11:00 am	Margaret Newman, Outgoing Chief of Staff, New York City Department of Transportation	USA	The New York City decision to retrofit 250,000 LEDs
		11:35 am	Edward Smalley, Director, Municipal Solid State Lighting Consortium	USA	The Advantages & Achievements of a Collaborative Municipal (Local Government) Programme
	THE AUSTRALIAN EXPERIENCE	12:10 pm	Graham Mawer, Director of Street Lighting Improvement Programme, Southern Sydney Regional Organisation of Councils (SSROC)	AUS	Councils co-operating for best value from utility-owned road lighting
		12:25 pm	Paul Gowans, City of Sydney	AUS	The City of Sydney LED Experience
		12:40 pm	Questions & Discussion (Session)		
 Harvard Engineering UK	LUNCH	12:55 pm	Lunch, Exhibition and Networking	UK	Harvard Engineering Lighting Controls sponsorship
	IMPROVING EFFICIENCY WITH TECHNOLOGY	1:55 pm	Terry Collins, General Manager Products, Energy Efficiency & Conservation Authority (EECA)	NZ	Harnessing Efficiencies in New Zealand's Road Lighting Landscape
		2:10 pm	Richard Webster, Electrical Services Manager ITS & Street Lighting, Suffolk County Council.	UK	A case study on lighting control systems
		2:30 pm	Christophe Orceau, CEO Streetlightvision & Chairman of the TALQ Consortium:	FRA	The current state and future of road lighting control
		2:50 pm	Chris Byrne, Chairman, Lighting Council New Zealand	NZ	NZ Lighting Industry Capability
		3:05 pm	Questions & Discussion (Session)		
AFTERNOON TEA	3:20 pm	Afternoon Tea, Exhibition and Networking		Strategic Lighting Partners Management Consultancy sponsorship	
 Strategic Lighting Partners	IMPROVING SAFETY WITH TECHNOLOGY	3:50 pm	Nancy Clanton, Chair, IES Outdoor Environmental Lighting Committee and Mesopic Committee, Boulder, USA	USA	Research shows yellow lighting is the wrong colour
		4:10 pm	Mr Bill Frith, Research Leader (Road Safety), Opus International Consultants	NZ	Quantifying the impact of road lighting on New Zealand road safety
		4:30 pm	Godfrey Bridger, Director, Strategic Lighting Partners	NZ	LED lighting and controls research presents a new paradigm
		4:45 pm	Questions & Discussion (Session) and Wrap-up for the Day		
 Citelum	CITELUM COCKTAILS	5:00 pm	Welcome by Adam Carey, Managing Director Citelum Australia & NZ	AUS	Citelum Australia & NZ - Lighting Performance Contractor sponsorship
	GE LIGHTING DINNER	7:30 pm	Welcome by Ian Killick, Acting Managing Director, GE Lighting Australia & New Zealand	AUS	GE Lighting NZ
		Bill Ralston – After Dinner Speaker			
		10:00 pm	The City Dark - Documentary Screening		Introduced by Thorn Lighting

Conference Speakers Day 2: Wednesday 12 March



NZ Transport Agency



Westpac



Beca



Silver Springs Network

DAY 2: Wednesday 12 March	Time	Speaker		Topic/Activity
Exhibition	8:30 am	Exhibition and networking , tea/coffee		NZTA – Conference Partner
WELCOME	8:55 am	Introduction		Strategic Lighting Partners Ltd
THE CHANGING REGULATORY ENVIRONMENT	9:00 am	Nigel Parry, ILP UK Principal Lecturer, CIE Division 4 Editor	UK	Directions in European Road Lighting Regulation & Standards
	9:20 am	Alistair Scott, Independent Consultant, Chair, British Lighting Standards Committee, Member European Standards	UK	Energy Reduction Strategy using the new British Standard
	9:40 am	Graeme Culling, AS/NZS Committee Member, Senior Lighting Engineer, Betacom	NZ	Australia New Zealand Standards: accommodating the move to LED
	9:55 am	Questions & Discussion (Session)		
MORNING TEA	10:10 am	Morning Tea, Exhibition and Networking		Westpac Institutional Bank Project Financier sponsorship
FUNDING, FINANCE & ECONOMICS	10:40 am	Dr Rune Elvik, Chief Research Officer Institute of Transport Economics, Norway.	NOR	The economic value of good Road Lighting - by video
	11:00 am	Michelle Hjort, Associate Director, RealTerm Energy, Canada	CAN	If It's Such a No-Brainer to give the "Green-Light" LEDs, Why Are Yours Still Orange?
	11:20 am	Stephen Proctor, Executive Director, Public Infrastructure Partners Fund	NZ	NZ Road Lighting Public Private Partnership (PPP) Opportunities
	11:35 am	Lynley Hutton, Investment Assessment Manager, NZ Transport Agency	NZ	Investment criteria for the new technology
	11:50 am	Questions & Discussion (Session)		
INNOVATIVE PROCUREMENT	12:00 pm	Bryan King, Director, Strategic Lighting Partners Ltd	NZ	Smart Procurement and innovative business models for LED Street Lighting
	12:15 pm	Ewan Gebbie Energy Mangement Association of NZ	NZ	NZ Energy Performance Contracts
	12:30 pm	Duncan Halliwell, Kensington Swan	NZ	Product and Performance Warranties and Risk Management
	12:50 pm	Questions & Discussion (Session)		
LUNCH	1:00 pm	Lunch, Exhibition and Networking		Beca Engineering Consultancy sponsorship
THE NZ EXPERIENCE	2:00 pm	John Rodger, Group General Manager, Corporate Development, Vector	NZ	Are streetlight networks logical investments for Electricity Network Companies?
	2:15 pm	David Raven, Odyssey Energy	NZ	Monitoring the performance of lighting assets
	2:30 pm	Keith Gibson, IESANZ New Zealand Chair	NZ	NZ Road Lighting Design Capabilities
	2:45 pm	Geoff English, Transport Asset Management Team Leader, Christchurch City Council	NZ	NZ Council Case Study
	3:00 pm	Questions & Discussion (Session)		
AFTERNOON TEA	3:15 pm	Afternoon Tea , Exhibition and Networking		Silver Spring Networks Smart Networks integrator sponsorship
THE FUTURE	3:30 pm	Roger Dennis, Executive Director, Sensing City Organisation	NZ	Intelligent Cities & Sensing Networks
	3:50 pm	CJ Boguszewski, Senior Director, Smart City Solutions, Silver Spring Networks, USA	USA	Weaving a Smart City Together: The Case of Copenhagen Lighting
	4:10 pm	Margaret Newman, Executive Director, Municipal Arts Society, New York	USA	Smart Cities - a vision for the Next 10 years
	4:25 pm	Round-table Wrap-up - Keynote Speaker Panel		
	4:55 pm	Final Remarks - Strategic Lighting Patners		

Conference Speakers Day 2: Wednesday 12 March



Nigel Parry

Institute of Lighting Professionals UK Principal Lecturer, CIE Division 4 Editor

Nigel Parry is the UK Member and Editor of the International Commission on Illumination (CIE) "Division 4" standards, responsible for "Lighting and Signalling for Transport". In the UK he is also

Professional Services Advisor for the Institution of Lighting Professionals (ILP), has his own Lighting Design consultancy "Array Lighting", and works for OrangeTek LED road lighting luminaire manufacturers.



Alistair Scott

MD, Designs for Lighting Ltd; Past President and Fellow of the ILP; Chair, British Standards Lighting Committee

Alistair Scott has spent more than 25 years in design and managerial positions within the lighting industry, having been Engineering Director with Urbis-Schreder

Lighting prior to heading up Designs for Lighting in 2005. He specialises in advising on energy reduction strategies for Local Authorities and energy efficient lighting design. He chairs the BSI committee EL/001/02 "Road Lighting" which published BS5489-1 in 2013 and he sits on the European CEN Joint Working Group working on the revision of EN 13201 Road Lighting standards. Alistair is the author of the Highway Electrical Association "Guide to the Intelligent Lifetime Management of Public Lighting Life Safety Engineering Systems".



Graeme Culling

Senior Lighting Engineer, Betacom; AS/NZS Road Lighting Standards Committee Member

Graeme has been involved with the design, testing and production of road lighting luminaires for over 35 years. His work includes the engineering disciplines involved in mechanical, electrical and photometric

design as well as photometric measurements. He has been a member of the AS/NZS Road Lighting committee that is responsible for the AS/NZS 1158 series of standards – since its formation in the joint format in 1990. Graeme is a Chartered Professional Electrical Engineer, a Fellow of the IES (The Lighting Society of Aus and NZ) and a Member of the ILP (UK).



Dr Rune Elvik

Chief Research Officer, Institute of Transport Economics, Oslo

Dr Elvik is lead editor of the internationally acclaimed Handbook of Road Safety Measures and joint editor-in-chief of the journal Accident Analysis and Prevention. He is Professor of Road Safety Studies

at Aalborg University (Denmark) and Lund University (Sweden). His main areas of research include evaluation of the effects of road safety measures, research synthesis by means of meta-analysis, and cost-benefit analysis. He has taken part in international research organised by the European Commission, the OECD, the European Transport Safety Council and the US Transportation Research Board. He is a member of the Norwegian Association of Political Scientists, the Society for Risk Analysis, and the New York Academy of Sciences.



Michelle Hjort

Associate Director, RealTerm Energy, Canada

In her present role Michelle Hjort supports Canadian municipalities with the project management and financing to implement LED streetlight retrofits. In her previous role at LightSavers Canada, a non-profit promoting the uptake of LED lighting across Canada,

Michelle developed a national market consortium assisting municipal and provincial governments, public institutions, and private companies that own or manage lighting assets to be aware of the opportunities of LED lighting and also to surmount the many barriers to understanding, procuring and implementing the technology.



Stephen Proctor

Executive Director, HRL Morrison & Co (Public Infrastructure Partners Fund)

Steven Proctor heads up the investment activity of the Public Infrastructure Partners Fund (PIP Fund). PIP Fund is an NZ based fund investing in PPP's, joint ventures and public infrastructure projects where the

principal customer is local or central government. Steven has been working in the infrastructure and PPP sector since 1995. Within the sector Steven has worked as Sponsor (purchasing and bidding infrastructure projects), Lead Arranging Banker (lending into several United Kingdom project finance transactions), and as a Financial Advisor, advising both project developers and various governments.



Lynley Hutton

Investment Assessment Manager, NZ Transport Agency

Lynley Hutton is Investment Assessment Manager at the NZ Transport Agency. She was the project manager for the Road Maintenance Task Force, having led – or been involved in - change initiatives in

other sectors. Lynley's background includes planning, monitoring, research, business analysis and policy support in central government. Her interest's include change management, organisational learning, writing fiction and going for very long walks in far-off lands.



Bryan King

Director, Strategic Lighting Partners; Executive Director, Lighting Council NZ

Bryan is a highly experienced practitioner and recognised authority on road lighting practices worldwide. Bryan is a member of the AS/NZS1158 Road Lighting Standards committee and is Convenor

of the AS/NZS1158 Lighting Controls Working Group. He has a 30 year history of leadership and governance in luminaire design, manufacture, application and consultancy businesses for the professional and municipal lighting sectors. Bryan was founding Chairman and is currently Executive Director of Lighting Council NZ and is a member of the Illuminating Engineering Society of ANZ and the Energy Management Association of NZ.

ROADLIGHTING | 2014 |

Innovation · Efficiency · Safety



Ewan Gebbie

Energy Management Association of NZ

Ewan has been Executive Officer of EMANZ since April 2009. In that time EMANZ has introduced a range of initiatives to boost the capacity and capability of the NZ energy services sector, such as establishing specialist training courses and adapting an Australian building energy performance rating scheme to New Zealand (NABERSNZ). Ewan has been involved in the technical and stakeholder advisory groups for NABERSNZ, and is also a member of the Retail Advisory Group for the Electricity Authority. Prior to joining EMANZ, Ewan was Regulatory Manager at energy and fibre utility Vector, bringing with him a wide range of industry and government experience.



Keith Gibson

IESANZ New Zealand Chair

Keith Gibson is the current chair of the New Zealand Chapter of the IESANZ. He is a Technical Director and Technical Lead for the Building services division at Beca, one of the largest New Zealand owned international engineering consultancies. Keith Gibson has held the position of Technical Convenor, representing the Society on technical matters to both the Standards Associations of Australia and of New Zealand in matters relating to lighting. Keith has an extensive background and history in lighting design, application and review, with particular emphasis on sports floodlighting, street lighting and the evaluation of glare, and regularly appears as an Expert Witness at resource Consent and Environmental Court hearings.



Duncan Halliwell

Senior Associate, Kensington Swan

Duncan is a construction and projects lawyer who has advised on large scale infrastructure projects both in the UK and in New Zealand. He advises on all project matters including contract procurement, drafting, and negotiation, and contract administration. He is the team's key specialist in FIDIC, NEC and other overseas standards. He also has in-depth knowledge of the all New Zealand standards including 3910, 3915, NZIA and NZTA's standard forms. Duncan's street lighting experience includes advising on major street lighting replacement projects for LB Ealing, Walsall MBC, Dorset County Council and Surrey County Council.



Geoff English

Team Leader, Transport Asset Management, Christchurch City Council

Geoff is the Transport Asset Management Team Leader at the Christchurch City Council. For over 30 years he has been involved in the design, maintenance and management of the road lighting network in the Christchurch area. In 2000 he became a member of the Australia and New Zealand Road Lighting Standards Committee and in 2009 was lead consultant of the team that developed the road lighting resources for the Electricity Commission's RightLight website. He is also a member of the Local Government Energy Management Roundtable's road lighting project.



John Rodger

Group General Manager Corporate Developments, Vector

John joined Vector in 2006 as Senior Legal Counsel and Manager of Strategic Relationships Vector to advise on all aspects of Vector's business and manage Vector's strategic relationships team. His dual role was testament to his ability to bridge the commercial-legal divide and deliver results that matter to the business. Prior to joining Vector he was Senior Legal Counsel for O2 UK and led a team responsible for new product development and delivery in UK, and for O2's presence in Asia Pacific and Middle East. John moved into the corporate world when he joined Orban in 2001 after three years as an Associate with Freshfields Bruckhaus Deringer.



Roger Dennis

Founder, Sensing City

Roger Dennis is working with leaders in local and central Government to rebuild the earthquake devastated city of Christchurch (in New Zealand) with a carpet of sensors to measure everything from traffic flow to water use in real time. Prior to this he worked around the world with organisations to understand where the world was going and how they should take advantage of macro changes. He's worked alongside the Prime Minister's team in the Singapore Government, the GameChanger team at Shell and numerous other organisations both large and small. Roger has lived in Hong Kong, Sydney and London and now is based in Christchurch.



David Raven

Odyssey Energy

David has been involved with street lighting since emigrating to NZ 15 years ago. In this time, he has undertaken numerous Lux Mapping surveys in both NZ and Australia and carried out a number of lighting upgrade trials and lighting designs. Before emigrating, he spent the first 14 years of his working life in England in the electrical control and automation industry.



CJ Boguszewski

Senior Director, Smart City Solutions, Silver Spring Networks, USA

CJ Boguszewski is currently involved in managing a major public lighting modernization for the City of Copenhagen as part of a city target to achieve a carbon-free footprint by 2025. His business unit has overseen the negotiations with other project participants, including lighting operator Citelum, and is developing the network architecture for this €80M+, 40,000 LED luminaire retrofit. Prior to taking up the Copenhagen project, CJ helped establish SSN's presence in Brazil and also ran its Advanced Metering Infrastructure business. CJ has more than 20 years' experience in ICT working with Vodafone, Oracle, CIBER and others.



Margaret Newman Executive Director, Municipal Arts Society, New York (See biography page 2)

Margaret Newman's new role consolidates her position as an advocate for intelligent urban design, planning and preservation.

Conference Partners, Supporters and Sponsors

New Zealand Transport Agency (NZTA)



NZTA creates transport solutions for a thriving New Zealand through its four core business functions: Planning the land transport networks, investing in land transport, managing the state highway network, and providing access to and use of the land transport system.

Energy Efficiency and Conservation Authority (EECA)



Energy Efficiency and Conservation Authority
Te Tari Tiaki Pūngao

Energy Efficiency and Conservation Authority (EECA) is the government agency that works to improve the energy efficiency of New Zealand's homes and businesses, and encourage the uptake of renewable energy.

Strategic Lighting Partners Ltd (SLP)



SLP is a specialist consultancy in facilitating the collation and analysis of information on LED road lighting applications for councils and road controlling authorities in New Zealand and Australia. SLP is the organiser of Road Lighting 2014.

Local Government New Zealand (LGNZ)

**We are.
LGNZ.**

LGNZ represents the national interests of councils in New Zealand and leads best practice in the local government sector, providing advocacy and policy services, business support, advice and training to assist its members to build successful communities throughout NZ.

Road Controlling Authorities (RCA) Forum



The RCA Forum is an officials group with representatives from 66 territorial local authorities, the Department of Conservation, Local Government New Zealand and the New Zealand Transport Agency. It is a forum for resolving issues of common concern.

Lighting Council New Zealand (LCNZ)



Lighting Council New Zealand represents the industry with regard to the formulation of regulation, compliance and environmental issues. LCNZ members participate in the formulation of International Standards, ensuring the industry is in step with other parts of the world. LCNZ aims to encourage improvement in lighting practices, promote ethical standards, advance the professionalism of the lighting industry and promote its interests in New Zealand.

NZ Society of Local Government Managers (SOLGM)



SOLGM is the professional organisation for local government management in New Zealand. SOLGM represents and supports its members, local government managers and staff through professional development and networking opportunities, membership support services, good practice resources and advocacy work.

Energy Management Association of NZ (EMANZ)



EMANZ promotes the highest standards of Energy Management skills and competence to foster and facilitate the integration of sound Energy Management practices into all sectors of the New Zealand economy. It is a collaborating technical society of the Institute of Professional Engineers New Zealand (IPENZ) which supports its members through a range of activities that raise skills, knowledge and all-round competence in energy management.

Illuminating Engineering Society of Australia and New Zealand Ltd (IESANZ)



The aim of the Society is the advancement of the art and science of illumination and the dissemination of knowledge to all interested parties. The Society's diversified membership includes engineers, architects, educators, students, contractors, manufacturers and designers. The Society operates under the name: IES: The Lighting Society.

ROADLIGHTING | 2014 |

Innovation · Efficiency · Safety

GE Lighting

Luminaire Supplier sponsorship



GE Lighting is the professional division of General Electric specialising in lighting solutions all around the world. GE was born

from the invention of the world's first affordable incandescent lamp. More than a century later, its Lighting business still brings light to the world, helping advance new technologies such as light-emitting diodes (LEDs) and new generation high intensity discharge lamps, that operate with more efficiency, less cost and less environmental impact than ever before.

Citelum

Lighting Performance Contractor sponsorship



Citelum is a global leader in lighting, traffic management, and other urban electrical systems. Citelum, specialises in urban electrical equipment. From urban lighting to traffic management, cities turn to us to manage their public lighting, lighting for

heritage buildings and monuments, traffic lights, and more recent urban electrical equipment needs like electric vehicle charging terminals, video surveillance, and traffic-light radars.

Harvard Engineering Plc

Lighting Controls sponsorship



UK-based Harvard Engineering Plc is a world leader in the design, development and manufacturing of electronic HID ballasts, LED drivers and control products for the lighting industry. We supply some of the most innovative and efficient products for commercial, retail, emergency and street lighting applications.

Silver Spring Networks

Smart Networks Integrator sponsorship



Silver Spring Networks is the world's leading smart energy platform and solutions provider. Silver Spring's standards-based IPv6 networking

platform connects utilities to customers and cities to communities, achieving greater operational efficiencies, increasing network reliability and empowering consumers to better manage energy consumption. For more information, visit www.silverspringnet.com.

Transfield Services

Construction & Maintenance Contractor sponsorship



Transfield Services is an operations, maintenance and construction services business, operating globally in the resources, energy, industrial, infrastructure, property and defence sectors. We work closely with our clients, helping them to achieve their business outcomes through optimising the sustainable performance, integrity and output of their assets.

Beca

Engineering Consultancy sponsorship



Beca provides professional services in roading, engineering, planning, project management, survey and valuations to clients on a global basis. An employee-owned, independent company, Beca has an international resource of 2500+ technical and decision-support staff. Beca Building's team of road lighting specialists have extensive experience in providing cost effective solutions for new and existing roads, motorways, and intersections throughout New Zealand. Silver Spring Networks

Westpac Institutional Bank

Project Financier sponsorship



We don't fit customers to products. We take a 360 degree view of your corporate finance needs, identify the best strategy, then maximise value for you by delivering a tailor-made solution. We'll work hard, hand-in-glove with you, bringing energy and drive to the project to match yours, and in the process, forge a strong partnership.

University conference supporter



Massey University is a leader in lighting research and teaching. Our photometric laboratory on our Albany (Auckland) campus measures everything from chromaticity coordinates to luminous flux. We have the Graduate Certificate in Science and Technology (Lighting), the only New Zealand course accredited by the IESANZ.

The City Dark documentary screening hosted by Thorn



Thorn is part of the Zumtobel Group, a Global leader in Luminaires and Control systems.

Conference Exhibitors

Advanced Lighting Technologies Ltd (Booth 13)



Advanced Lighting Technologies (ADLT) has operated in the Australian and NZ markets for over 20 years focusing on providing long life, energy efficient, sustainable lighting solutions.

ADLT are the distributors for the CREE range of exterior luminaires. USA based Cree are recognized internationally as one of the true innovators & have revolutionized the lighting industry with their extensive range of well proven, cost effective, high performance LED lighting products for road, path & area lighting applications.

Betacom Ltd (Booth 2)



Betacom are New Zealand's leading exterior lighting manufacturer of road, area,

functional and decorative lighting. Our leading edge technology together with our Christchurch based manufacturing facilities allow us to manufacture to meet New Zealand conditions. We complement this by distributing both the BEKA and Schreder ranges. 2014 showcases the launch of several new LED luminaires

CSP Pacific (Booth 11)



CSP Pacific are the market leader in the manufacture and supply of Lighting Poles and Columns and roadside safety products. With over 40 years in business and backed by New Zealand's largest listed company, Fletcher Building, CSP Pacific provide quality innovative products to ensure New Zealand's roads are safer.

Downer ITS (Booth 34)



Downer ITS is the market leader in Intelligent Transport Solutions in New Zealand. We provide traffic signals, CCTV, public lighting services and more.

ECC Lighting (Booth 19)



iGuzzini is one of the largest manufacturers of innovative, architectural lighting in Europe and have been a partner of ECC for over 25 years.

Wow, U.F.O. and the Woody family are their

leading LED street lighting solutions. Recent street lighting projects include Eden Park Carpark, Lorne St, Fort St, Daldy St and Halsey St. www.ecc.co.nz

Echelon Inc (Booth 17)



Headquartered in Silicon Valley, Echelon develops, markets and supports the world's most proven, open standard, multi-application energy control networking platform.

Our technology platform is embedded in more than 100 million devices, 35 million homes, and 300,000 buildings. Echelon offers innovative solutions including smart metering, smart grid optimization, smart street lighting, and smart buildings.

Energy Light Ltd (Booth 29)



Energy Light is a New Zealand owned and operated lighting company, who has partnered with LRL (LED Roadway Lighting).

LRL are a Canadian manufacturer of LED roadway luminaires, designed for longevity and efficiency. The LRL 'NXT' was awarded "Best In Class" at the 2014 Next Generation Luminaire Awards.

Enlightenz Ltd (Booth 23)



Enlightenz is committed to the energy-efficient lighting market, and delivers cost-effective projects of distinction across all commercial, industrial and local

government markets. We invest in the development of leading luminaires for NZ and export markets, and are proud to achieve projects that deliver more and more value over their economic life.

GE Lighting (Booth 28)



GE Lighting is the professional division of General Electric specialising in lighting solutions around the world. GE was born from the invention of the world's first affordable incandescent lamp. More than

a century later, its Lighting business still brings light to the world, helping advance new technologies such as LEDs.

Gerard Lighting (NZ) Ltd (Booth 26)



Gerard Lighting New Zealand presents the most comprehensive range of major brands ever assembled in the New Zealand market forming a "one-stop shop" for all the trade's lighting needs.

Our passion for service, support and delivery will ensure Gerard Lighting New Zealand forms New Zealand's No. 1 lighting solutions provider to the trade market.

Illuminating Engineering Society of Australia and NZ (IESANZ) (Booth 10)



The aim of the Society is the advancement of the art and science of illumination and the dissemination of knowledge to all interested parties. The Society's diversified membership includes engineers, architects,

educators, students, contractors, manufacturers and designers. The Society operates under the name: IES: The Lighting Society.

KTL Technologies (Booth 15)



KTL Technologies are electronic product specialists, focused on the design and development of sophisticated lighting produces and innovative electronic systems. NZ owned and operated, the

company employs a team of registered architects, electrical engineers, product designers, and project managers to drive a project from concept and design through to manufacture and installation.

ROADLIGHTING | 2014 |

Innovation · Efficiency · Safety

LED Innovations Pty Ltd (Booth 16)



LED Innovations will be launching the US built Cooper Lighting Navion AUS-XNV Residential 22 watt LED Streetlight in NZ. With industry leading patented optics, the Navion AUS-XNV delivers state-of-the-art optical control, rugged construction, simple maintenance, modern styling and meets AS/NZS 1158 Category P4, P4R and P5 spacing requirements.

Lucy Zodion (Marine Instruments Ltd) (Booth 14)



Lucy Zodion is a leading UK manufacturer and supplier of street lighting equipment, supplying a wide range of low voltage fused street lighting isolation products, photo-electric control units, electronic control gear, sheet steel and cast iron pillars and associated equipment. Our environmentally friendly products offer low consumption and exceptional control.

Lux Review Australia (Booth 4)



Technology and the need to save energy are transforming the world of lighting. Lux Review Australia is the most authoritative and engaging magazine for lighting decision-makers. We publish the best case studies of retrofit and new build lighting projects, independent product tests, as well as sharp analysis and debate on the hottest trends in the sector.

Lux Mapping - Odyssey Energy Ltd (Booth 8)



Lux Mapping is a service unique to Hamilton-based Odyssey Energy. In contrast to traditional inspection methods, Lux Mapping gives an accurate performance measure of each light unit at night and has all the benefits of real-time measurement. This vehicle-mounted system allows fast and efficient monitoring of road lighting without impeding traffic.

Massey University (Booth 5)



Massey University is a leader in lighting research and teaching. Our photometric laboratory on our Albany (Auckland) campus measures everything from chromaticity coordinates to luminous flux. We have the Graduate Certificate in Science and Technology (Lighting), the only New Zealand course accredited by the IESANZ. Find out more at massey.ac.nz/lighting.

ONROADLED.com (Booth 12)



ONROADLED.com is on the road to establishing a new lighting standard with products based on a unique combination of wireless power transfer and LEDs. Together these technologies create an intelligent, efficient and resilient lighting system for affordable installation over long distances in diverse settings. It features individually programmable lights, and spark-free safety for hazardous environments.

Orangetek (Booth 32)



OrangeTeK specialise in public lighting products that make use of LED lighting technology. We design our LED street lights to cut down energy consumption without sacrificing performances. OrangeTek's aim is to use our knowledge in LED light technology and help to make our society more sustainable.

Silver Spring Networks (Booth 20)



Silver Spring Networks is the world's leading smart energy platform and solutions provider. Silver Spring's standards-based IPv6 networking platform connects utilities to customers and cities to communities, achieving greater operational efficiencies, increasing network reliability and empowering consumers to better manage energy consumption.

Spectratech Lighting Ltd (Booth 22)



Spectratech Lighting Ltd: distinctive brands, limitless lighting possibilities. NZ agents for Architectural Area Lighting USA, Beacon Lighting USA, Hubbell Lighting USA, International Lighting Australia, and Kim Lighting USA. Luminaires in our range incorporate innovative high-performance LED technology with aesthetic, architecturally relevant design. Also available are HID to LED luminaire upgrade kits for existing installations.

Targetti Lighting (Booth 31)



With over 40 years experience servicing the architectural lighting market, we continue to lead the market with innovative and technically advanced lighting solutions that utilise the latest and most robust lighting technologies. With leading World brands Targetti Poulsen and Simes we supply sustainable interior and exterior solutions at the forefront of design.

TechLight Ltd (Booth 6)



Specialising in external lighting projects, Techlight have the products, skill and experience to ensure your project is brilliantly realised. Our portfolio of LED road lighting and urban lighting luminaires use the highest quality components to maximise efficiency and lifespan. Our lighting design specialists can work with you to achieve the result you want.

Telensa (Booth 25)



Telensa is the leading street light wireless monitoring and control system supplier with installations across the globe (UK, Australia, NZ, USA, Brazil, Mexico) and managing more than half a million street lights. Since 2006 Telensa has successfully managed the smooth implementation of multiple city-wide and region-wide street light Central Management Systems.

Thorn Lighting (Booth 1)



Thorn is part of the Zumtobel Group, a Global leader in Luminaires and Control systems. At Road Lighting 2014 Thorn will be exhibiting an abbreviated showcase of LED Road and Urban Lighting products. International Thorn Staff will also be present to advise and discuss applications applicable to New Zealand.

Transfield Services (Booth 9)



Transfield Services is an operations, maintenance and construction services business, operating globally in the resources, energy, industrial, infrastructure, property and defence sectors. We work closely with our clients, helping them to achieve their business outcomes through optimising the sustainable performance, integrity and output of their assets.

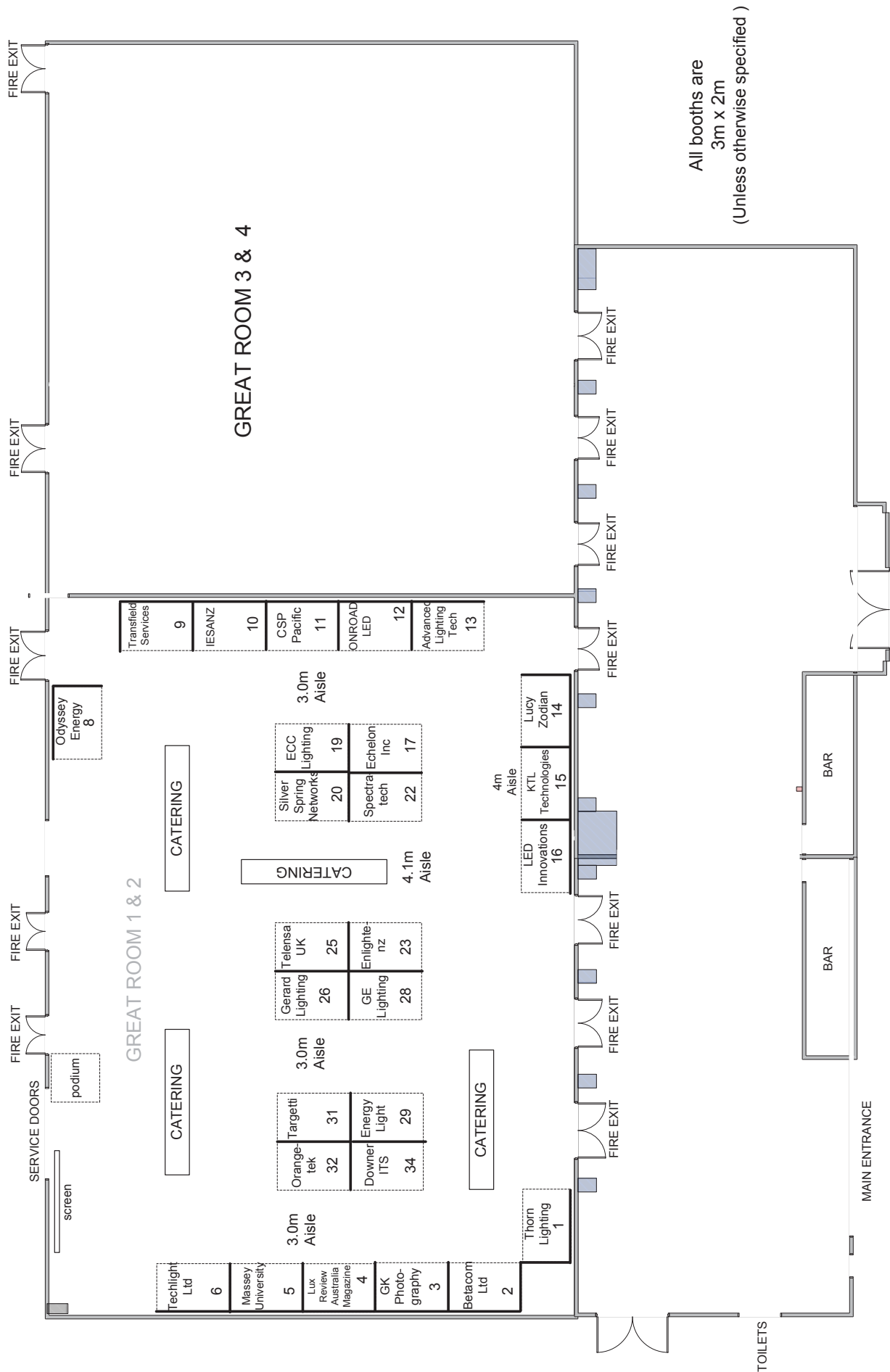

All booths are
3m x 2m
(Unless otherwise specified)



Road Lighting Conference – 11th & 12th March 2014
VENUE: The Langham Hotel – The Great Room 1

DRAWN BY: H.Eason
DATE DRAWN: 07/02/14
Ph: 09 574 6574
Email: h.eason@displayways.co.nz



ROADLIGHTING | 2014 |

Innovation · Efficiency · Safety



ROADLIGHTING | 2014 |

Innovation · Efficiency · Safety

11-12 March Auckland New Zealand

*Lighting application photographs courtesy of
Advanced Lighting Technologies NZ Ltd*



Conference organised by:

Strategic Lighting Partners

Godfrey Bridger +64 21 274 3437

Bryan King +64 21 300 111

Crystal Beavis +64 275 957 927

www.strategiclightingpartners.com

godfrey@strategiclightingpartners.com

bryan@strategiclightingpartners.com

crystal@strategiclightingpartners.com